

QUICK TIPS FOR INSTALLING VINYL SIDING

For best results, use certified vinyl siding and colors certified for color retention. The VSI Vinyl Siding Installation Manual, found at vinylsiding.org, provides more information about how to install vinyl siding and accessories. Please see the manufacturer's instructions.

Visit vinylsiding.org for more information.



TOOLS



STANDARD ACCESSORIES

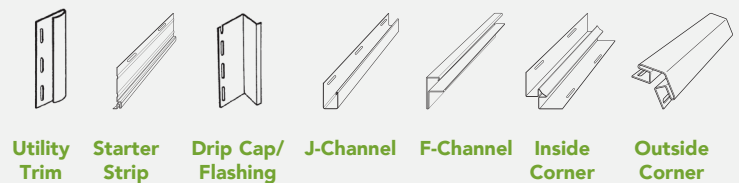

*All accessories should be nailed 8"-12" max on center.

TIPS FOR A SUCCESSFUL INSTALL

STARTER STRIP

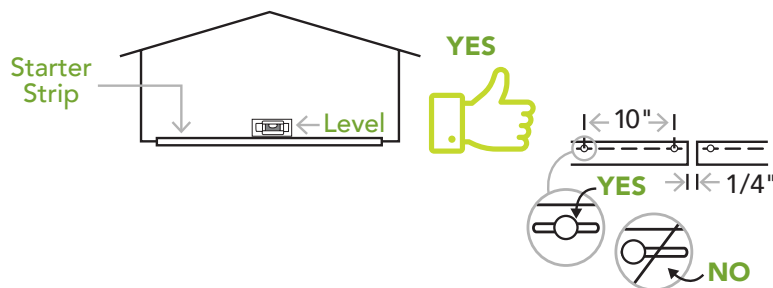

CUTTING VINYL SIDING

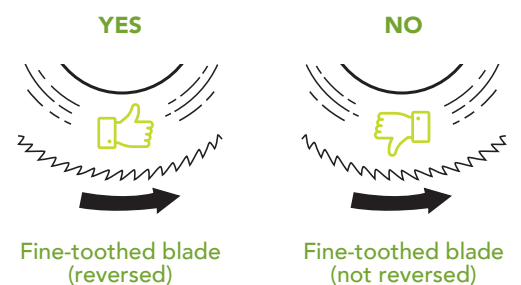

(OR USE A VINYL SIDING BLADE)

DOORS AND WINDOWS

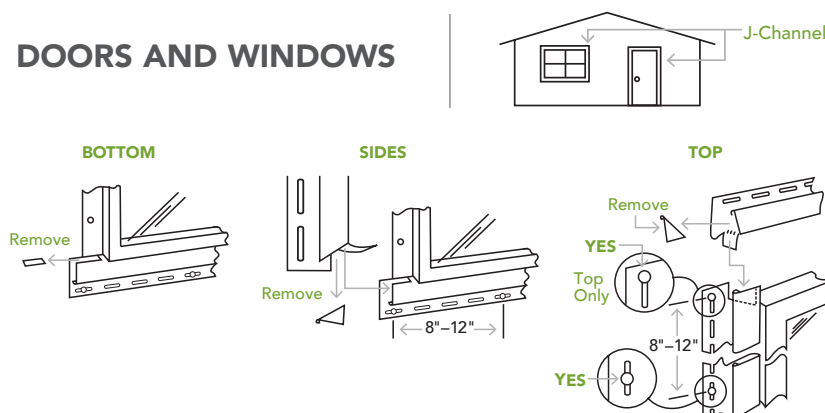

NAILING: Vertical Accessories or Siding

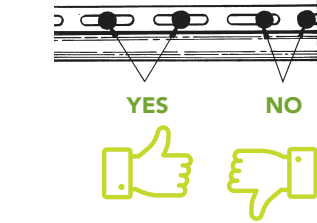
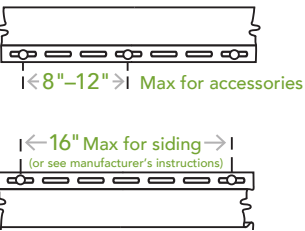
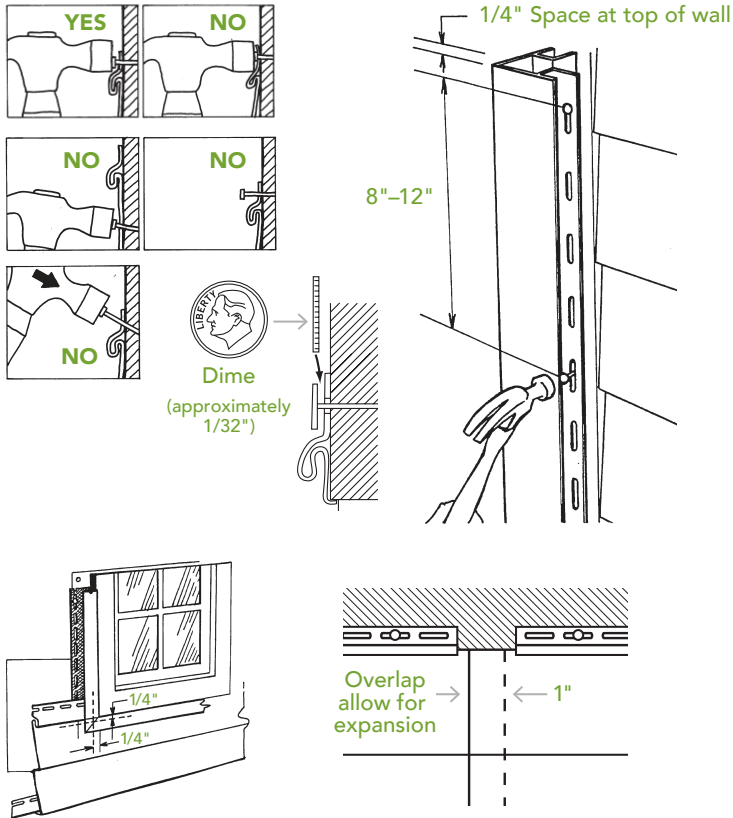

LOCKING PANELS

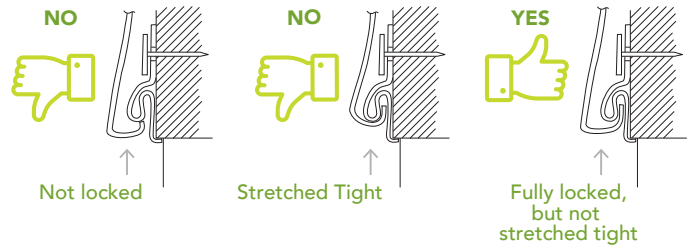

PANEL ALIGNMENT

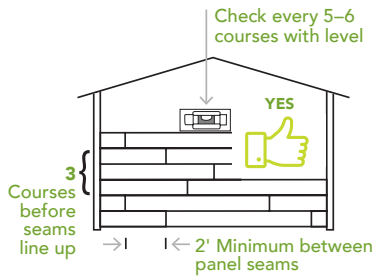

FINISHING: Last Course in Eave Options

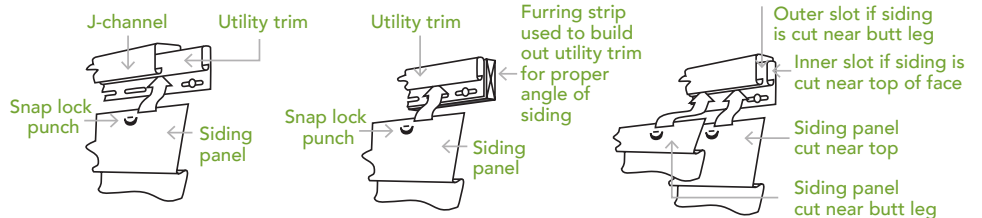

*Snap lock punches should be about 6" on center.